

**BE A DEER
SUITCASE**



I fondly remember my parents' brown luggage that we used for traveling during the 1980s. I also fondly remember that it weighed as much as a small child. Thank goodness suitcases have gotten lighter! The funny thing is that refurbishing luggage has become popular, but not necessarily for travel. People are fixing up suitcases for storage, room decorations, and even for cool craft-fair displays. Since silhouettes are never going to go out of style, I added one on the front for interest.



WHAT YOU'LL NEED MOD PODGE TOOL KIT ■ FABRIC MOD PODGE ■ SATIN MOD PODGE ■ OLD SUITCASE ■ OUTDOOR PAINT IN AQUA AND WHITE ■ 2 YARDS (1.8 M) OF FABRIC ■ CLIP-ART SILHOUETTE ■ STENCIL TAPE ■ ¼ YARD (22.9 CM) FABRIC IN A COORDINATING PRINT OR SOLID ■ CLEAR ACRYLIC SPRAY SEALER

WHAT YOU DO

- 1** Prepare the fabric with the Fabric Mod Podge, and allow to dry (A).
- 2** Paint both sides of the main body of the suitcase using the white outdoor paint. Do the trim using the aqua paint. Apply several coats, allowing each to dry before applying the next.

DESIGNER NOTE → *Painting the suitcase with a white base coat prevents the original color from dulling the fabric color.*

DESIGNER NOTE → *Rather than first making a pattern for cutting the fabric, I used Mod Podge to adhere larger pieces of the prepared fabric directly to the suitcase. Then I used a sharp craft knife to trim the fabric to fit. However, if you desire, you could make a pattern for cutting the fabric.*

- 3** Work on a small area of each section of the suitcase at a time. Apply a medium layer of Mod Podge to a section of the suitcase, and lay a piece of the fabric on it. Smooth the fabric toward the edges of the section, but do not glue the edges down.
- 4** Use a sharp craft knife to trim the fabric to fit (B) before finally Mod Podging the fabric to the edges of each section.
- 5** Print a clip-art silhouette of choice from the Internet using royalty-free clip art, and then cut it out with the craft knife (C).
- 6** Use the stencil tape to adhere the silhouette to the contrasting fabric, and then use scissors to cut it out.



HOME DÉCOR
BE A DEER SUITCASE

7 Apply a medium layer of Mod Podge onto the surface of the suitcase where you want the silhouette to go. Lay the silhouette on the Mod Podge, and smooth carefully. Allow to dry for 15 to 20 minutes.

8 Paint at least two coats of the Satin Mod Podge over the entire surface of the suitcase, including the silhouette and trim ☺. Be careful to avoid brushing the hardware.

9 Allow to dry for 24 hours before using. I highly recommend spraying the entire suitcase with the clear acrylic sealer to reduce any tackiness and to add durability.
TIP → *Take your time and work slowly on this project when applying and cutting the fabric to fit. Doing so will result in clean edges. Trim carefully, especially around the hardware.*



Mod Podge Tool Kit

You'll always need these items on hand for any project. Gather them early and keep them in one place. Nothing's worse than searching for something when you're in the middle of the creative flow. Each project will always tell you what Mod Podge formula(s) to use.

Mod Podge, formula(s) specified

**Mod Podge Tool Set,
includes one squeegee and one brayer**

Paper towels

Disposable foam plates or palette

Scissors

Craft knife and self-sealing mat

Water basin

**Brushes for applying Mod Podge
(disposable foam works well)**

Paintbrushes

Craft glue

Ruler

Tape measure

Pencil or pen

Sandpaper in a variety of grits

Steel wool, extra-fine to fine

Fabric

Wash and dry the fabric (do not use fabric softener). Iron, and then lay the fabric on a covered work surface—using wax paper to cover your table is preferable. Use a brush to paint a light coat of Fabric Mod Podge onto your fabric.

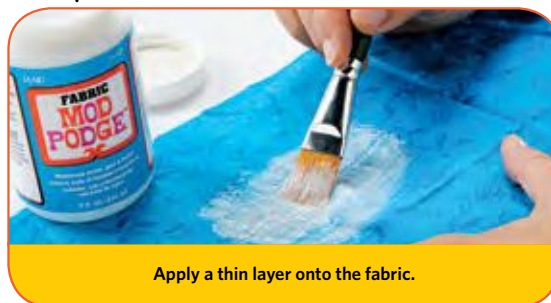

Apply a thin layer onto the fabric.

Allow the fabric to dry. This will enable you to cut the fabric like paper without worrying about frayed edges.



Notice the clean, unfrayed edges when cutting prepared fabric.